

**TRIM ROAD REALIGNMENT & ST. JOSEPH BOULEVARD & OLD MONTREAL ROAD WIDENING**



LANDSCAPING PLAN  
WATERS ROAD, SCHOOL BUS YARD ENTRANCE, SPRINGRIDGE DRIVE & PORTOBELLO BOULEVARD PLAN

Contract No. **ISD11-5147** Dwg. No. **L11**

Z. Ghaban, P. Eng. Manager  
J. Mojsesj, P. Eng. Project Manager

Asset No. \_\_\_\_\_

**Robinson Consultants** **GENIVAR**

Asset Group \_\_\_\_\_



Des. KD Chk'd. KD

Dwn. MF Chk'd. KD

Utility Circ. No. \_\_\_\_\_ Index No. \_\_\_\_\_

Const. Inspector \_\_\_\_\_

Scale: HORIZONTAL 0m 5 10 20 VERTICAL 0m 1 2

NOTE: The location of utilities is approximate only, the exact location should be determined by consulting the municipal authorities and utility companies concerned. The contractor shall prove the location of utilities and shall be responsible for adequate protection from damage.

No.	Description	By	Date (dd/mm/yy)
1	ISSUED FOR REVIEW	KD	25/05/12
2	ISSUED FOR TENDER	KD	29/06/12
3	ISSUED FOR CONSTRUCTION	KD	21/09/12

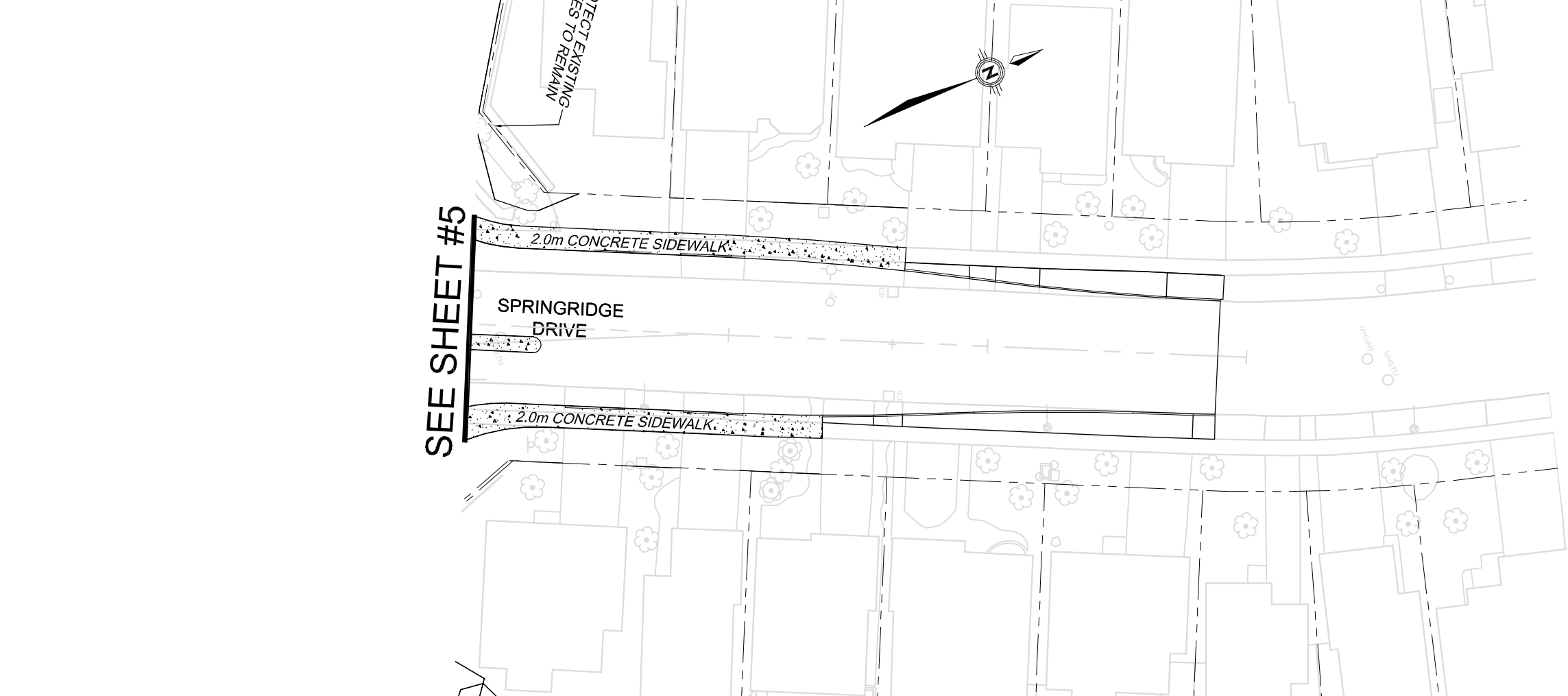
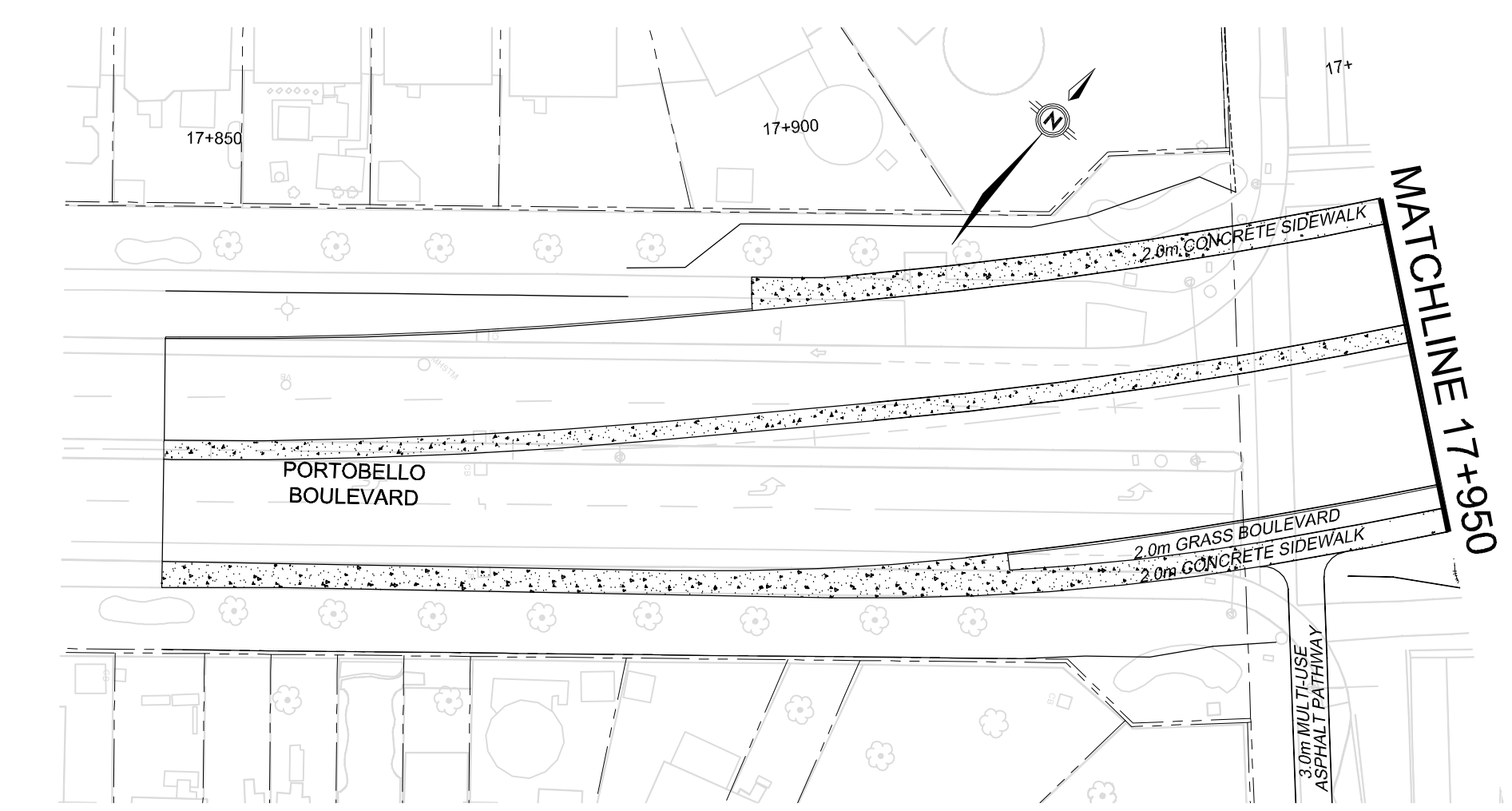
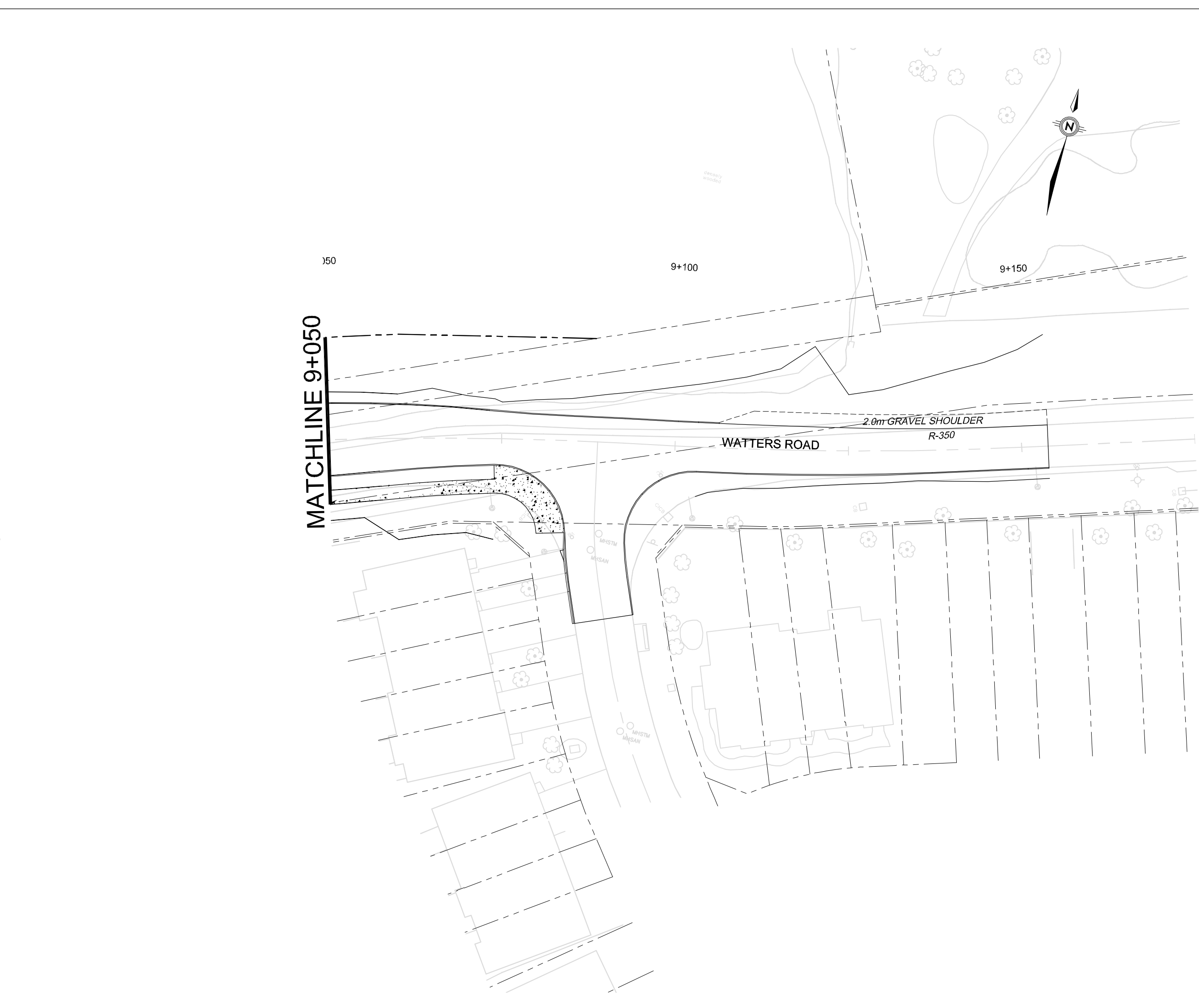
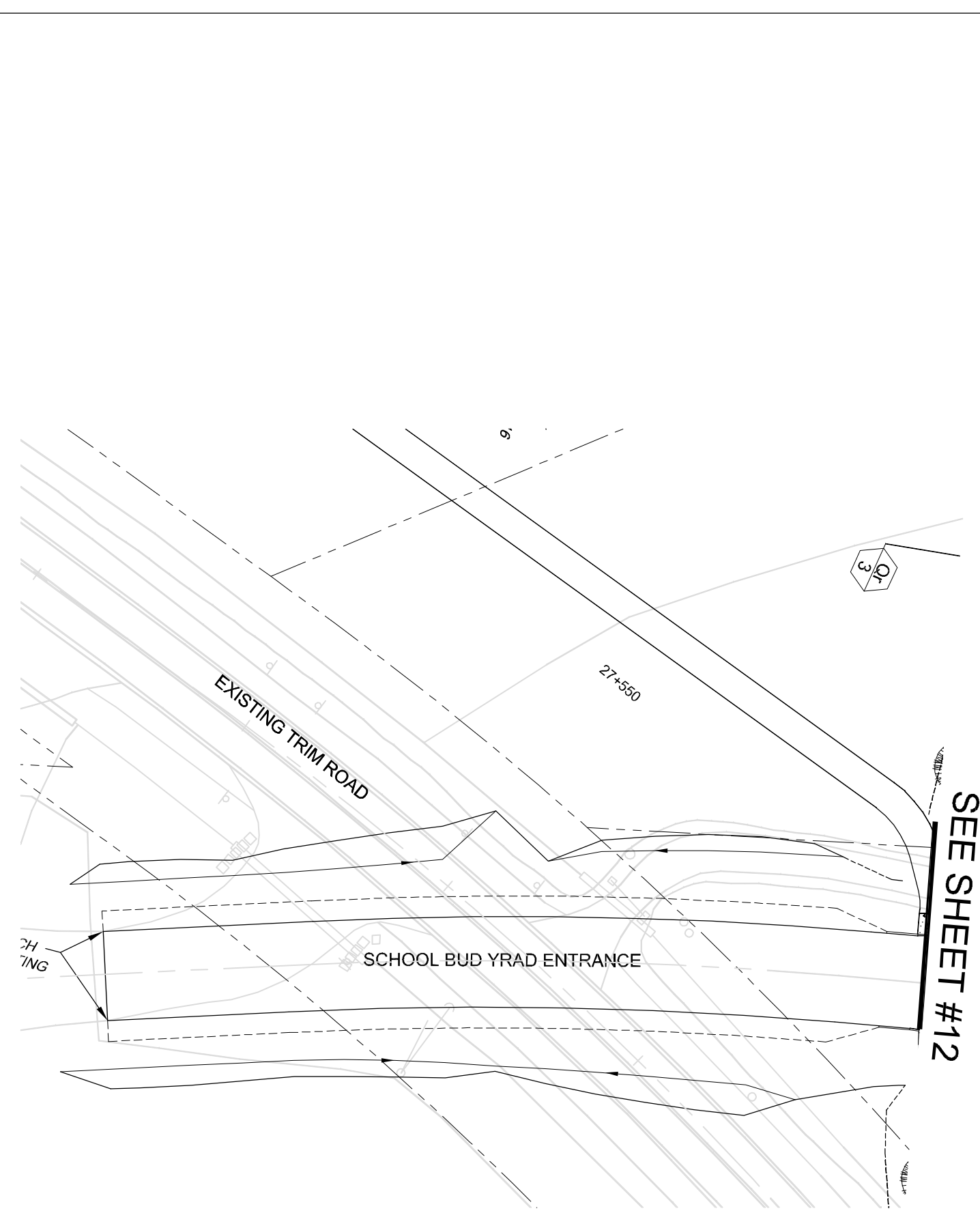
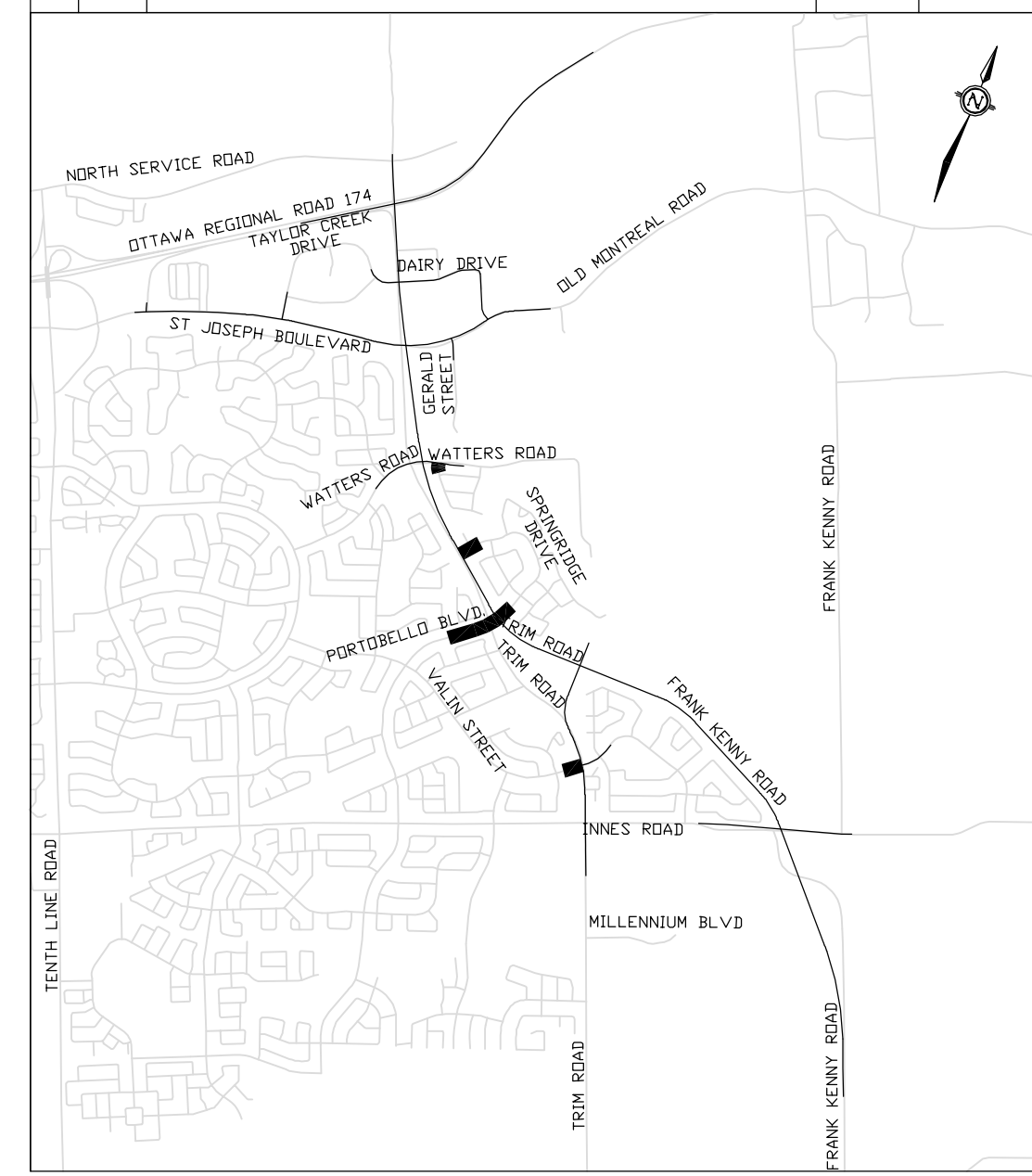

**NOTES:**

- ALL SITE INFORMATION SHOWN COMPILED FROM EXISTING MAPS. ALL DIMENSIONS MUST BE VERIFIED ON SITE AND REPORT ALL DISCREPANCIES.
- SERVICES PRIOR TO ANY EXCAVATION. CONTRACTOR TO REPAIR ALL DAMAGES AT NO COST TO OWNER(S).
- REINSTATE ALL AREAS DAMAGED BY CONTRACTOR OUTSIDE DESIGNATED WORK AREAS.
- ALL GRADED AREAS TO RECEIVE 100 mm TOPSOIL. SEED & MULCH UNLESS OTHERWISE SPECIFIED.
- ALL EARTH FILL TO BE COMPACTED TO 95% MAX. DRY DENSITY
- ALL SLOPES TO REMAIN WITHIN R.O.W. UNLESS OTHERWISE NOTED.
- EXCAVATION FOR TREES/SHRUBS TO BE INCLUDED IN THE UNIT PRICE BID FOR SUPPLY AND INSULATION OF TREES/SHRUBS.
- ALL MEASUREMENTS ARE IN METERS UNLESS OTHERWISE NOTED.
- PROTECT EXISTING TREES TO REMAIN. SHOWN.

**ISSUED FOR CONSTRUCTION**